

FOR LEASE



Tanner Place Condominiums

718 NW 11th Avenue

For Lease: 1,643 Square Feet
(Ground Floor Retail/Service/Creative Office)

CONTACT

Kathleen Healy 503 208 8184
kathleen.healy@bencocre.com
and Ben McInnis 503 208 8182
ben.mcinnis@bencocre.com)



About the Space

Tanner Place Condominiums is a mixed-use condominium (120-unit) and retail project that was built by developer Hoyt in 2002. There is one available retail space in the building: 1,643 square feet fronting NW 11th Avenue, on the Streetcar line and adjacent to Pearl Salon and Mabel & Zora clothing store. This 2nd generation retail space is well appointed for the next retail, service retail, or creative office user. It comes

complete with large glass storefront, HVAC, electrical and lighting distributed throughout, one ADA restroom and hardwood flooring. Other neighboring co-tenants within the building include Visage Eyewear, Pearl Audio Video, Parallel and Sinju. Jamison Square Park is within ½ block of the space, as well many other successful area retailers and restaurants.



CONTACT

Kathleen Healy 503 208 8184
kathleen.healy@bencocre.com
and Ben McInnis 503 208 8182
ben.mcinnis@bencocre.com)



The Area

Thanks in large part to developer Hoyt, among other local developers and visionaries, this area that was once comprised of rail yards and industrial buildings has been transformed into a 100-block mecca of retail, condominiums, apartments and offices. Portland Streetcar weaves throughout the neighborhood, and numerous parks dot a thriving landscape. Hoyt is the area's largest developer with 11 mixed-use projects completed to date (including Tanner Place Condominiums) and more in the planning stages.

The area has become a destination for local and out-of-town visitors, as well as thousands living and working in the neighborhood who enjoy supporting their local retailers and food/drink establishments.

The area has many noteworthy destinations, including REI, Bridgeport Brewpub, Posh, Lovejoy Bakers, Sammy's Flowers, Piazza Italia, Sinju, West Elm, Patagonia, Powell's Books, Andina, Lizard Lounge, Oba, Irving Street Kitchen, and many more.

There are also abundant retailers servicing this dense neighborhood, including financial services (every major bank has a presence in the area), grocery (Safeway and Whole Foods), insurance companies, salons and spas, wellness clinics, and athletic facilities (24-Hour Fitness and LA Fitness).



CONTACT Kathleen Healy 503 208 8184
kathleen.healy@bencocre.com
and Ben McInnis 503 208 8182
ben.mcinnis@bencocre.com



Site Plan

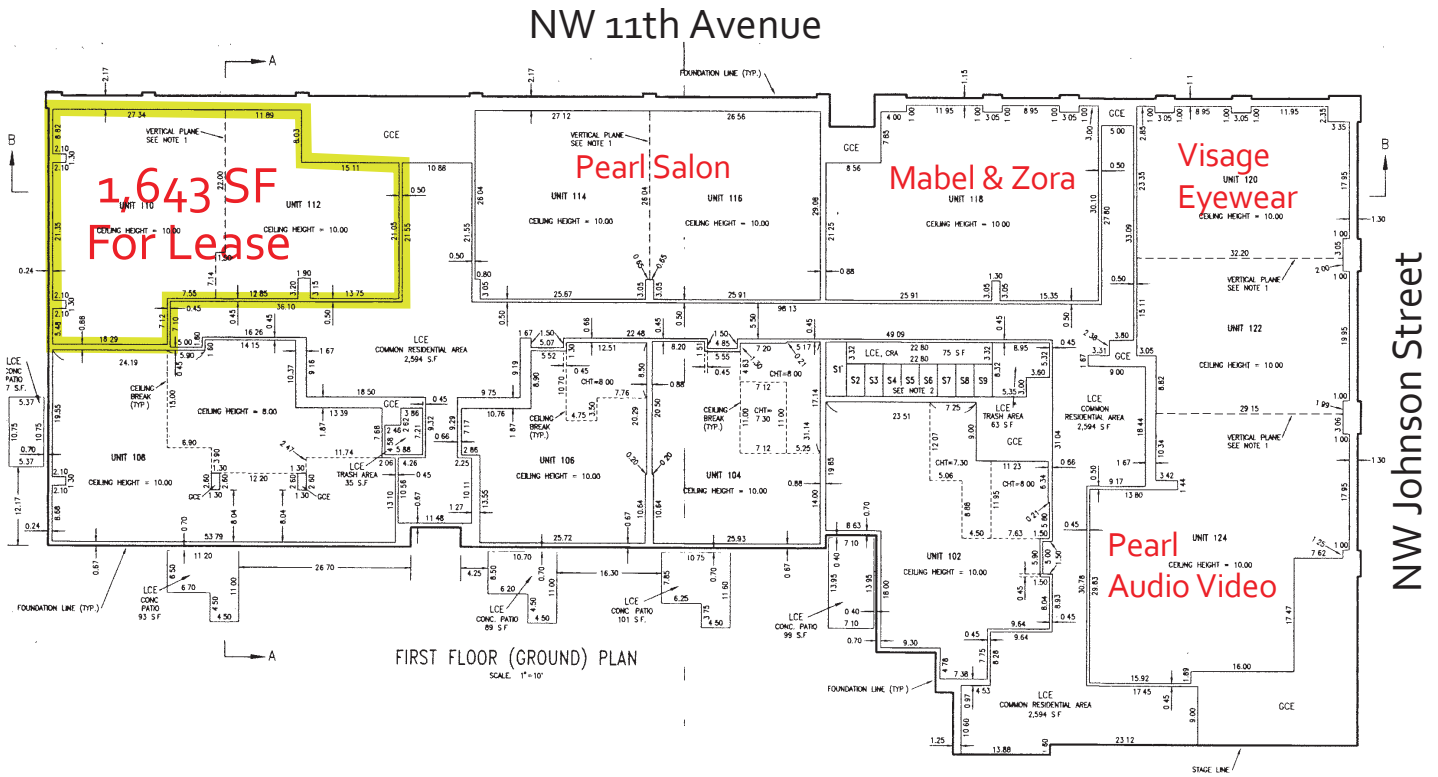

CONTACT Kathleen Healy 503 208 8184
 kathleen.healy@bencocre.com
 and Ben McInnis 503 208 8182
 ben.mcinnis@bencocre.com



Area Map



CONTACT

Kathleen Healy 503 208 8184
 kathleen.healy@bencocre.com
 and Ben McInnis 503 208 8182
 ben.mcinnis@bencocre.com

